



In-Line Repairable Metal Seated Ball Valves



SEAMLESSLY INTEGRATED MANUFACTURING

Delivers Highest Quality. Faster Results. Lower Costs.

www.vestravalve.com

SEAMLESS INTEGRATION. SUPERIOR PERFORMANCE.

By fully integrating every critical step of the manufacturing process, Vestra Valve has redefined how high-performance, metal-seated ball valves are designed, built, and delivered. We've eliminated silos, handoffs, and geographic barriers to create a unified, start-to-finish operation that delivers unmatched quality, speed, and value.

ONE TEAM. ONE PROCESS. ONE OUTCOME - PERFECTION.

At Vestra Valve, our engineers don't stop at design. They partner with customers, develop tailored solutions, source materials, operate precision machinery, and ensure quality in real time. The result: valves built with deep expertise, total accountability, and personal ownership at every stage.

BETTER. FASTER. COST-EFFICIENT.

Direct engagement drives superior performance and quality. Streamlined workflows shorten schedules and reduce lead times. Operational efficiency reduces production costs – enabling Vestra Valve to deliver the highest quality products, with faster turnaround and highly competitive pricing.

BLOCK AND ISOLATION SERVICES

COMPLIANCE, CODES & STANDARDS

- ✓ ISO 9001:2015
- ✓ ASME B16.34
- ✓ ASME B16.5
- ✓ ASME B31.1
- ✓ ASME B31.3
- ✓ ASME TDP-1 2023
- ✓ ASME BPVC Section 1
- ✓ ISO 5211 (Actuator Mounting)
- ✓ ISO 5211 (Actuator Mounting)
- ✓ API 6D Compliant
- ✓ NACE MRO175/MRO103
- ✓ MSS SP-25
- ✓ Federal Trade Commission (FTC), 16 CFR Part 323 (Made in USA)

PRESSURE TEMPERATURE RATINGS:

- ✓ ANSI 150 through 4500
- ✓ Standard (STD), Special (SPC), & Limited (LTD) Classes

AVAILABLE END CONNECTIONS

- ✓ NPS 3/4" (20 mm) and Up
- ✓ Socketweld, Butt weld, Flanged, & Threaded Ends

STANDARD BODY MATERIALS:

- ✓ SA-105
- ✓ SA-182 F22 CL 3
- ✓ SA-182 F91
- ✓ SA-182 F92
- ✓ SA-182-F316/F316L
- ✓ Other Materials Upon Request



AT VESTRA VALVE, QUALITY MEANS ZERO LEAKAGE – EVERY VALVE, EVERY TIME.

SEATING COMPONENTS

- ✓ Pressure Assist Seating and High Strength Belleville Spring Ensure Zero-Leakage Shutoff at All Pressure Differentials
- ✓ Rocket Applied, Chromium Carbide Coatings
- ✓ Industry Leading Hardness, Resistant to Erosion, Corrosion, and Thermal Shock
- ✓ Constant Contact Seating Surfaces Protected from Flow
- ✓ Mate-Lapped for Full, 100% Contact Seating Surfaces

OPERATING MECHANISM

- ✓ Integral T-Shoulder Blowout Proof Stem
- ✓ Live-Loaded Packing and 1/4 Turn Operation for Zero Fugitive Leakage and Minimal Wear and Tear
- ✓ Robust Mounting Bracket Supports All Actuation Methods in Any Position
- ✓ Extended Mounting Bracket Accommodates Power Industry Practices for High Temperature Insulation Thickness.
- ✓ Hard Stops on the Mounting Bracket Prevent Actuation Over Travel and Guarantee a Perfect Ball and Seat Alignment in the Open Position

IN-LINE REPAIRABILITY

- ✓ Split Body Design Allows for Full Replacement of All Critical Seating Components Without Removal the Actuator

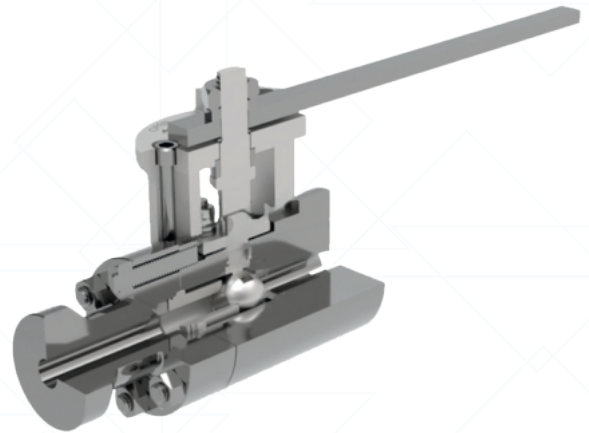

INLINE REPAIRABILITY

All Performance Critical Sealing and Seating components are Fully Replaceable with Brand New, Factory-Made Parts with Minimal Fieldwork, No Welding and Without Actuator Removal.

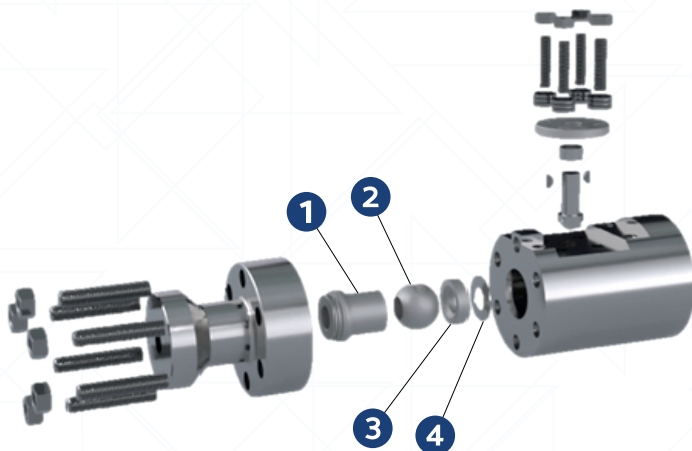

INTERNAL REPLACEMENT PART KIT



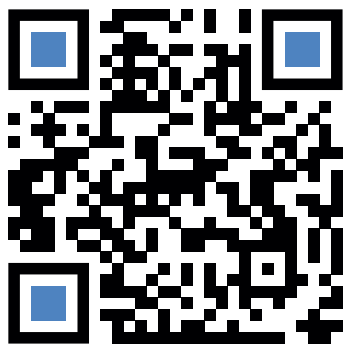

Item	Description
1	Core
2	Ball
3	Guide
4	Belleville Spring

ABOUT VESTRA VALVE:

Based in Houston, Texas, Vestra Valve is a leading innovator in high-performance, severe-service, in-line repairable, metal-seated ball valves for industries such as Power Generation, Oil & Gas, Chemical, Mining, and Pulp & Paper. The company proudly delivers 100% American Content – 100% Made in America.



Contact Info:

-  281-310-1094
-  sales@vestravalve.com
-  www.vestravalve.com
-  6230 Bingle Rd. Houston, TX 77092